



31 The Meadows, Wibsey, Bradford, BD6 1LF

**** TWO BEDROOM RETIREMENT BUNGALOW ** 75% SHARE **** Situated on this sought after development just on the outskirts of Wibsey Village and the required amenities on offer. The Development known as 'The Meadows' is a retirement complex all of a similar nature and is Warden controlled. Set within well maintained grounds, this Bungalow has open aspect to the rear and comprises of entrance hall, lounge, dining kitchen, two bedrooms and MODERN shower room. Double glazing and gas central heating. **** VIEWING ADVISED ****

£97,500

T 01274 601119 **E** wibsey@robertwatts.co.uk **W** robertwatts.co.uk
Wibsey Office: 140 High Street, Wibsey, BD6 1JZ

f [RWEstateAgents](#) **t** [@robertwatts_](#)

[arla](#) | [propertymark](#) [naea](#) | [propertymark](#)

31 The Meadows, Wibsey, Bradford, BD6 1LF

ENTRANCE HALLWAY

Large entrance hallway with 2 store cupboards

LOUNGE 13' x 12'1" (3.96m x 3.68m)

Feature fireplace and pleasant outlook over the grounds

DINING KITCHEN 10' x 11'4" (3.05m x 3.45m)

Fitted kitchen with a range of wall and base units, worktops with sink and drainer, eye level oven with separate hob and extractor. Plumbing for washer.

BEDROOM ONE 12'4" x 9'8" (3.76m x 2.95m)

BEDROOM TWO 8' x 7'5" (2.44m x 2.26m)

SHOWER ROOM

Good size shower room with walk in double shower and vanity style sink and W.C

OUTSIDE

Parking area and pleasant well kept communal gardens

LEASEHOLD DISCLAIMER

N.B. Our client has advised us that this property is leasehold, this information should be verified by your solicitor prior to proceeding with any purchase. Additional management charges / ground rent may be payable. Please contact the office for any further details.

The Fixtures & Appliances included have not been tested and therefore no guarantee can be given that they are in working order. Every care has been taken with the preparation of these sales particulars, but complete accuracy cannot be guaranteed. If there is any point, which is of particular importance you should obtain independent verification, or we will be pleased to check them for you. These sales particulars do not constitute a contract or part of a contract.



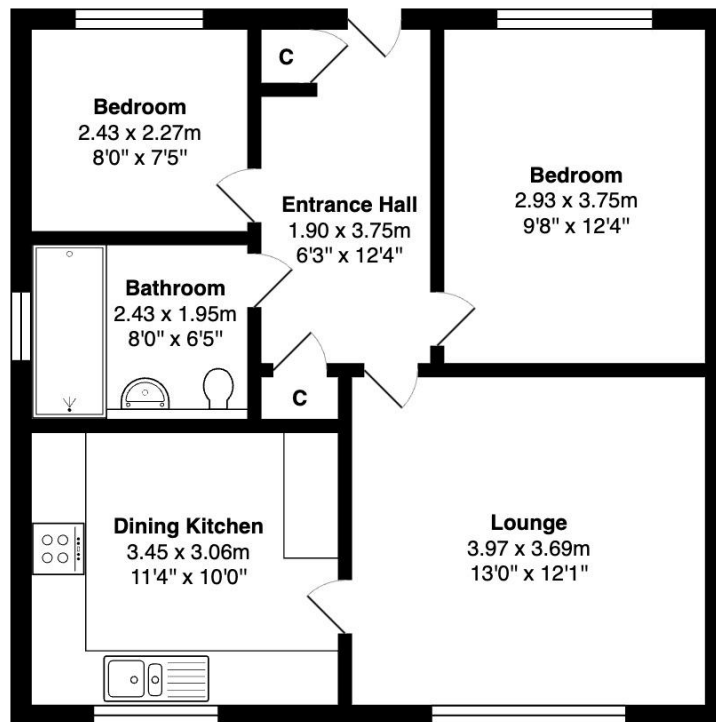

Ground Floor

Total Area: 57.6 m² ... 620 ft²

All measurements are approximate and for display purposes only

