



4 Carr Bottom Avenue, Bankfoot, Bradford, BD5 9BE

**** OFFERED WITH NO CHAIN ** IDEAL YOUNG FAMILY HOME **** Viewing is strongly advised for this lovely INNER TOWN HOUSE offering THREE BEDROOM accommodation. Benefitting further from dining kitchen, MODERN SHOWER ROOM, GCH DG and pleasant gardens to front and rear. Situated within this INCREASINGLY POPULAR RESIDENTIAL AREA of Bankfoot, ideal for many amenities, primary and secondary schools, public transport links and much more.

Asking Price £140,000

T 01274 601119 **E** wibsey@robertwatts.co.uk **W** robertwatts.co.uk
Wibsey Office: 140 High Street, Wibsey, BD6 1JZ

f [RWEstateAgents](#) **t** [@robertwatts_](#)

[arla](#) | [propertymark](#) [naea](#) | [propertymark](#)

4 Carr Bottom Avenue, Bankfoot, Bradford, BD5 9BE

ENTRANCE HALL

LOUNGE 11'10" x 13'4" (3.6m x 4.06m)

Feature fireplace housing gas fire

DINING KITCHEN 11'10" x 10'6" (3.6m x 3.2m)

Good size dining kitchen with an array of wall and base units. Worktops with tiled splashback, sink and drainer. Oven, hob, extractor and plumbing for washer. Large pantry area with window, power and light

FIRST FLOOR

BEDROOM ONE 9'7" x 13'5" (2.92m x 4.1m)

BEDROOM TWO 9'7" x 10'5" (2.92m x 3.18m)

Built in store cupboards

BEDROOM THREE 7'8" x 5' (2.34m x 1.52m)

SHOWER ROOM Modern shower room with oversize shower, vanity style sink and W.C

OUTSIDE Lawned gardens to the front with potential to create off road parking (subject to permissions)
Good size lawned garden to the rear with permanent built outhouse

FURTHER INFORMATION Council Tax - Band B

Tenure - Freehold

The Fixtures & Appliances included have not been tested and therefore no guarantee can be given that they are in working order. Every care has been taken with the preparation of these sales particulars, but complete accuracy cannot be guaranteed. If there is any point, which is of particular importance you should obtain independent verification, or we will be pleased to check them for you. These sales particulars do not constitute a contract or part of a contract.



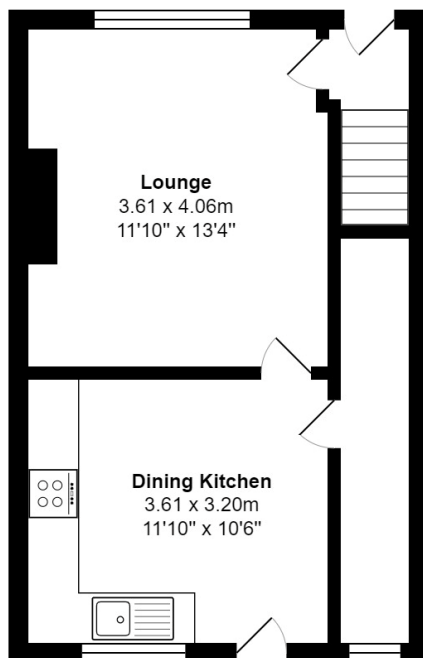

Ground Floor

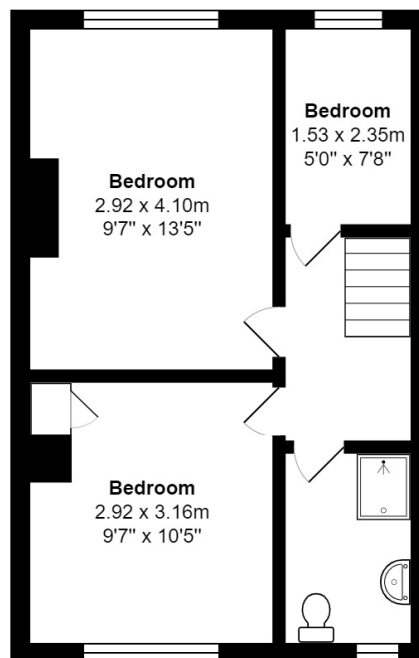

First Floor

Total Area: 68.1 m² ... 733 ft²

All measurements are approximate and for display purposes only

