



25 North Road, Wibsey, Bradford, BD6 1TR

**** OFFERED WITH NO CHAIN ** LARGE FOUR BEDROOM DOUBLED FRONTED FRONT TERRACED ** VILLAGE LOCATION **** Step inside this lovely, larger than average stone built terraced property situated in the heart of Wibsey Village. Briefly comprising: entrance vestibule, lounge and dining kitchen with access to a good size basement. TWO DOUBLE BEDROOMS to the first floor with family bathroom PLUS a further TWO BEDROOMS within the dormer attic area. Externally is a pleasant garden to the front. Well placed for all of Wibsey's amenities, schools, walks in the park and ideal for commute to neighbouring towns and cities. We feel this is an ideal property for first time buyers, young families and investors.

£145,000

25 North Road, Wibsey, Bradford, BD6 1TR

ENTRANCE VESTIBULE

LOUNGE 14' x 14'6" (4.27m x 4.42m)

Good size reception room with feature fireplace

DINING KITCHEN 17'9" x 6'5" (5.4m x 1.96m)

Fitted kitchen with an array of wall and base units. Worktops with sink and drainer. Oven hob and extractor, plumbing for washer. Access to the basement

BASEMENT

Great size with power and light

FIRST FLOOR

BEDROOM ONE 13'1" x 9'2" (4m x 2.8m)

BEDROOM TWO 14'7" x 8' (4.45m x 2.44m)

BATHROOM

Modern three piece suite with shower over bath, sink and W.C. Fitted cupboard

SECOND FLOOR

BEDROOM THREE 15'7" x 8'8" (4.75m x 2.64m)

Under eave storage

BEDROOM FOUR 7'11" x 9'8" (2.41m x 2.95m)

OUTSIDE

Pleasant, block paved garden to the front

The Fixtures & Appliances included have not been tested and therefore no guarantee can be given that they are in working order. Every care has been taken with the preparation of these sales particulars, but complete accuracy cannot be guaranteed. If there is any point, which is of particular importance you should obtain independent verification, or we will be pleased to check them for you. These sales particulars do not constitute a contract or part of a contract.



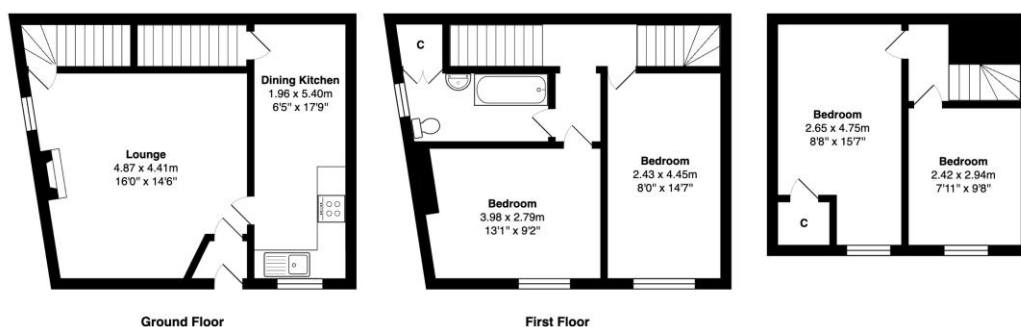

Total Area: 96.5 m² ... 1039 ft²
 All measurements are approximate and for display purposes only

